



# INSTALLATION GUIDE

PERFORMANCE TRANSMISSION COOLER, FITS CHEVROLET/  
GMC L5P 6.6L DURAMAX 2017-2019 | SKU: MMT-C-DMAX-17

## TABLE OF CONTENTS

**Pg 01** RESOURCES & CONTACT INFORMATION

**Pg 02** EXPLODED DIAGRAM

**Pg 03** PARTS BREAKDOWN

IMPORTANT SAFETY INFORMATION  
INSTALLATION INSTRUCTIONS

**Pg 06** DISPOSAL INSTRUCTIONS

WARRANTY INFORMATION

## RESOURCES & CONTACT



**CALL 1-877-GOMISHI**

CUSTOMER SERVICE HOURS: MON-FRI 8:30AM-5:00PM EST



**MISHIMOTO**



**GOMISHIMOTO**



**MISHIMOTO**



**WEBSITE**

[WWW.MISHIMOTO.COM](http://WWW.MISHIMOTO.COM)



**ENGINEERING BLOG**

[WWW.MISHIMOTO.COM/ENGINEERING](http://WWW.MISHIMOTO.COM/ENGINEERING)

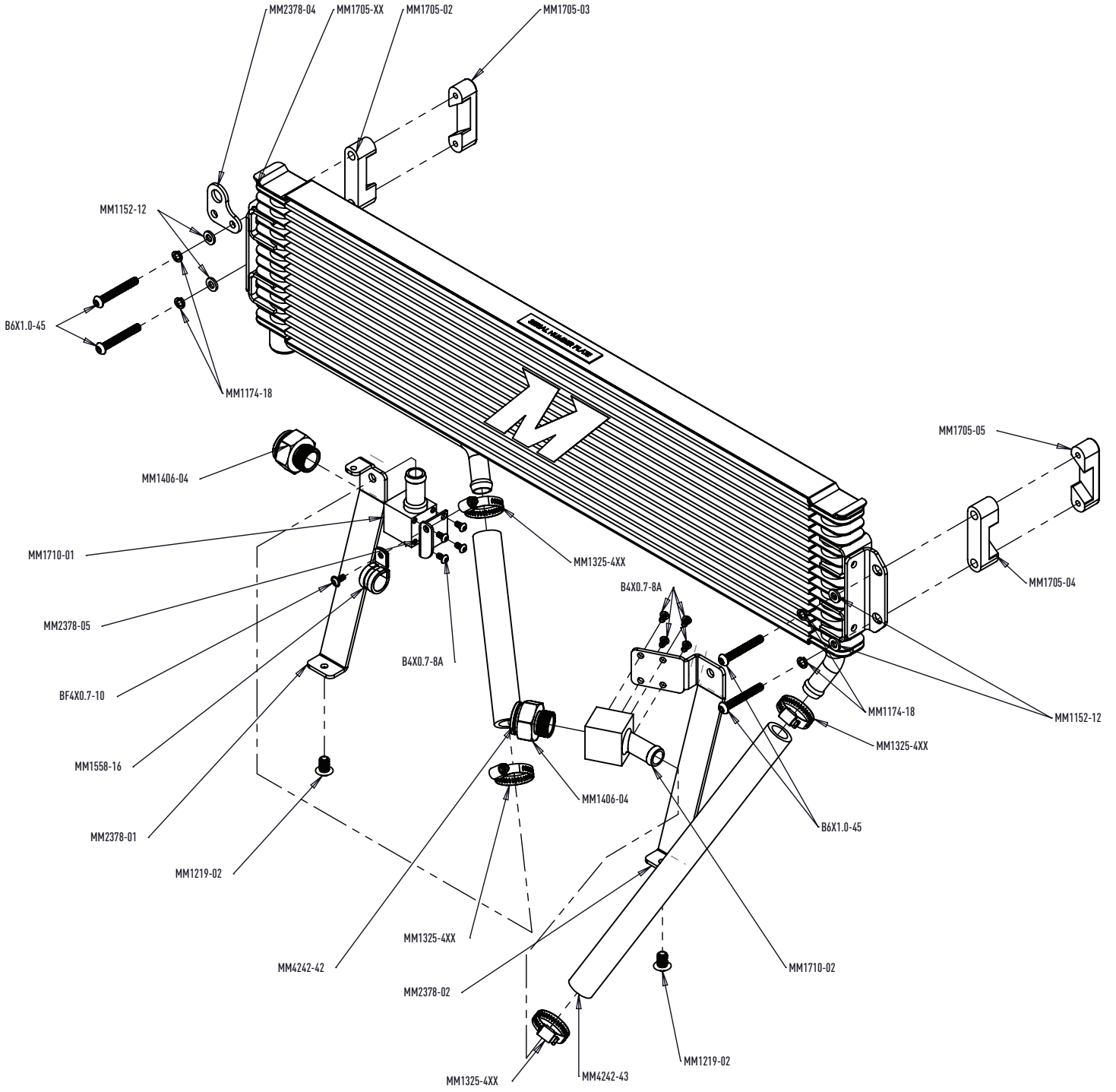

## PARTS BREAKDOWN

### MMTC-DMAX-17

MM1705-XX	CORE, BRACKETS	1
MM4242-42	HOSE	1
MM4242-43	HOSE	1
MM1710-01	ADAPTER	1
MM1710-02	ADAPTER	1
MM2378-01	BRACKET	1
MM2378-02	BRACKET	1
MM2378-04	BRACKET	1
MM1705-02	CLAMP	1
MM1705-03	CLAMP	1
MM1705-04	CLAMP	1
MM1705-05	CLAMP	1
MM1558-16	LOOP CLAMP	1
MM1219-02	POP CLIP	2
B4X0.7-8A	BOLT	8
BF4X0.7-10	BOLT	1
B6X1.0-45	BOLT	4
MM1163-03	LOCK NUT	1
MM1174-18	LOCK WASHER	4
MM1152-12	WASHER	4
MM1325-4XX	WORM GEAR CLAMP	4
MM1406-04	ADAPTER	2
MM2378-05	BRACKET	1

## IMPORTANT SAFETY INFORMATION

- › Mishimoto recommends you use safety glasses and protective gloves during the install of their products

- › Raise vehicle only on jack stands or on a vehicle lift
- › Allow vehicle to cool completely prior to attempting installation
- › Do not run the engine or drive the vehicle while overheating; serious damage can occur
- › Please dispose of any liquids properly
- › Mishimoto is not responsible for any vehicle damage or personal injury due to installation errors, misuse, or removal of Mishimoto products
- › If you need any assistance while installing our products, reach out to our Customer Service Team at 1-877-GOMISHI

## INSTALLATION INSTRUCTIONS

01. Remove rain guard by sliding forward (there is double-sided tape holding the guard to the fender that must be replaced).



02. Remove upper radiator support cover (12 pop clips).



03. Remove the upper part of the grille (4x 10mm bolts).

CONTINUED ON FOLLOWING PAGE



**04.** There are 10x clips that mount the grille, remove by pulling firmly on each clip.

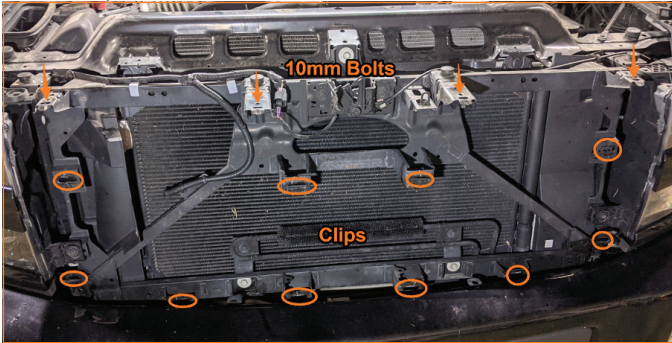

**05.** Unplug wiring harness connector from the center-bottom of bumper (be sure to disengage safety clip before unplugging).

**06.** Remove lower bumper brackets. If brackets are left bolted to the truck body, they will hit the bumper during removal (6x 15mm bolts).



**07.** Remove bumper bolts, and slide bumper forward to remove (4x 18mm bolts, locations shown without bumper).



**08.** Unclip plastic transmission cooler line brace, as well as removing plastic trans cooler line quick disconnect covers.

**09.** Using a pick tool, remove quick-disconnect retainer clips (kit comes with new fittings with retainer clips installed).



**10.** Unbolt stock transmission cooler and un-clip lower shield by pulling down on the shield. Remove longer transmission cooler line at the same time as the stock transmission cooler if more clearance is needed (2x 10mm bolts).



**11.** Install Mishimoto Transmission cooler to the front of core support using supplied brackets. To ease installation, all brackets should be installed, and core centered in position before hold-down bolts are tightened, be sure to tighten brackets evenly (4x 4mm hex socket).

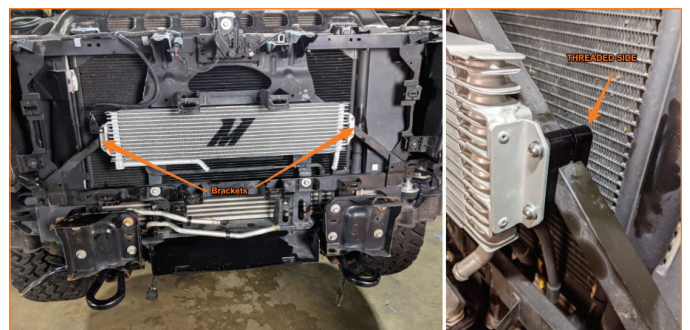

CONTINUED ON FOLLOWING PAGE



12. Install adapter bracket (MM2378-04) with upper hold-down bolt to relocate ambient air temperature sensor on the passenger side.



13. Install mounting brackets using stock transmission cooler mounting bolt locations and hardware, clip lower shield to brackets with supplied tree clips. Install P-clip around transmission line as shown. Refer to product diagram for bracket assembly. (8x 2.5mm hex socket bolts, 1x 2mm hex key w/ 7mm nut for P-Clip).

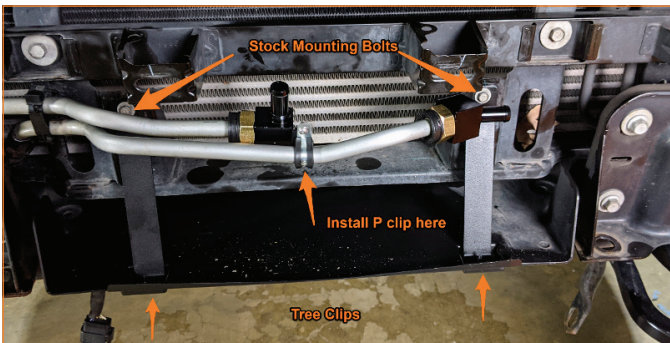

14. Install rubber lines with supplied worm gear clamps. The longer line gets installed on the driver's side of the cooler.

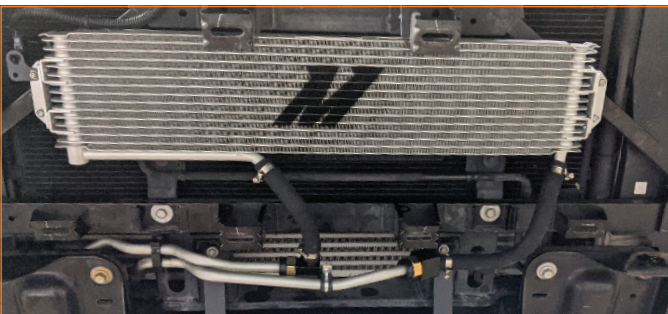

15. The 2017-2019 grille will not clear the driver-side rubber transmission cooler line. A portion of the lower grille will need to be trimmed.

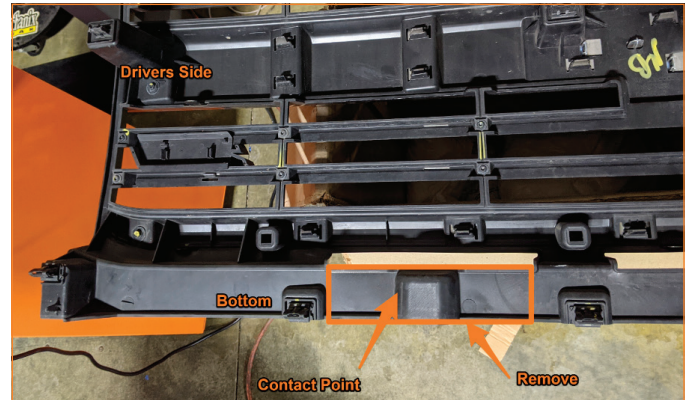

16. Install grille, upper rad support cover, and rain guard.



17. In order to re-install rain guard from step 1. Old double-sided "emblem tape" will need to be removed and new tape applied.

**Congratulations! You have finished your installation.**

**\*For Disposal Instructions and Warranty Information continue to the following page.**

## DISPOSAL INSTRUCTIONS

- › Do not dispose of any product as unsorted municipal waste. Use separate collection facilities. Contact your local authority for information regarding the collection systems available.
- › Never improperly dispose of any coolant, oil, or other chemicals.

## WARRANTY INFORMATION



- › All claims must be accompanied with a picture of the Mishimoto product showing the issue for which the claim is being submitted.
- › Mishimoto asks that the customer inspect their purchased item for any damage immediately upon arrival.
- › Any product deemed dead on arrival (DOA) must be claimed within 14 business days of delivery. Claims outside of this time frame will not be covered under the Mishimoto Lifetime Warranty.
- › This warranty does not include payment and/or reimbursement of the cost of labor in connection with the removal of any product returned pursuant to the warranty policy or in connection with the installation of any replacement items provided under the warranty policy.
- › Mishimoto has the right to refuse a claim at any time.
- › When Mishimoto accepts a claim, Mishimoto retains full discretion to choose if it will: (i) repair or replace purchaser's original Mishimoto product; (ii) replace purchaser's original Mishimoto product with the most current available model; or (iii) provide the purchaser with a gift card redeemable on [Mishimoto.com](http://Mishimoto.com) in the amount of the original purchase price of the original Mishimoto product. The provision of a replacement of a Mishimoto product is subject to availability and Mishimoto retains the right to substitute any warranty claim item with a comparable item or credit at any time.

- › If Mishimoto determines that it will provide a replacement item in connection with a claim under this warranty policy, and such item is out of stock, Mishimoto will place the customer on backorder and ship the replacement product to the purchaser once it becomes available.
- › Mishimoto is not liable for incorrect shipments in connection with a claim if a claim form is completed incorrectly, or if a model number is not included in a claim.
- › If you have a vehicle equipped with an automatic transmission, please make sure to specify this within the text box on the claim form. Mishimoto is not responsible for incorrect replacement shipments if transmission type is not indicated.



**WARNING**  
Cancer and  
Reproductive Harm  
[www.P65Warnings.ca.gov](http://www.P65Warnings.ca.gov)

This product can expose you to chemicals which are known to the state of California to cause cancer. For more information visit: [www.p65warnings.ca.gov](http://www.p65warnings.ca.gov)