



WARNING!

(MUST READ PRIOR TO INSTALLATION)

I. Water Ingestion Disclaimer:

This product is intended for general highway use only! Under normal driving conditions water ingestion is usually not an issue; however, if the product becomes submerged from rain splashes or mud puddles due to harsh rains or flooding the engine may ingest water which could cause severe engine damage. Do NOT use this product when crossing any body of water including but not limited to large puddles, streams, rivers or lakes.

If your engine ingests water, this could cause severe engine damage by hydro-lock or other conditions. Care should be taken to avoid these driving conditions. **ENGINE DAMAGE CAUSED BY THE INGESTION OF WATER INTO THE ENGINE IS THE DRIVER'S RESPONSIBILITY AND IS NOT COVERED BY S&B FILTERS!**

II. Scoop Obstruction:

Regularly inspect the entire Scoop Inlet for any obstruction or debris that may impede the flow of air.

III. Ride Height

Make sure there is plenty space between your tire and the scoop before driving. The scoop system may not work with aftermarket wheels and tires.

IV. Do NOT Seal Off Stock Inlet Location:

In addition to pulling air from the base of the air box, the S&B Cold Air Intake Kit pulls air from the same location as the stock induction system. **UNDER NO CIRCUMSTANCE SHOULD YOU SEAL OFF THIS AIR INLET.** Doing so could result in severe injury or death or damage to the vehicle or property. Sealing off the stock air inlet could cause a significant vacuum should the Scoop become partially or completely obstructed which among other things could pull oil into intake tube leading to an explosion and/or a run-away truck condition as the oil would serve as fuel to the engine.

V. Warranty for Scoop & Filter Wrap

S&B provides a limited warranty to guarantee the product is free of material and workmanship defects. Any product will be replaced upon identification of such defect. Normal wear and tear is not covered under this warranty. Final authorization is at the sole discretion of S&B Filters, Inc.

VI. How long will the Scoop & Filter Wraps Repel Water?

The Scoop & Filter Wraps are specially treated to repel water. The water repellency longevity is dependent upon driving conditions and the number of times the filter is cleaned. Generally speaking, we recommend changing the Filter Wrap every 6-12 months. However, a quick test can determine if it is time to change your Filter Wrap. Simply take an ordinary clean spray bottle filled with water and gently spray the Filter Wrap. If the water beads off the Filter Wrap, your water repellency is still working. If you see water enter through the Filter Wrap, it is time to purchase a new Filter Wrap.



INSTALLATION INSTRUCTIONS

Important: Read warning page prior to proceeding.

VEHICLE APPLICATION

Year: 2009-12
 Make: Chevy/ GMC
 Model: Silverado/ Sierra 1500
 (Trucks only)
 Engine: 4.8L, 5.3L, 6.0L, 6.2L

TOOLS REQUIRED

- Ratchet and Extensions
- 7mm, 7/16", 10mm Sockets
- 10mm, 7/16" Wrenches
- 5/16" Nut driver
- Flat and Phillips Screwdrivers
- Pliers

Thread Locker Use

We have provided a small tube of thread locker in your kit. Whenever you see the symbol above on a step of the instructions apply 1 small drop of the thread locker to the threads of the screws or bolts. This will keep your hardware from vibrating loose during rough driving. If the hardware ever needs to be removed, do so slowly to avoid having the inserts strip out from the plastic. DO NOT USE ON LID HARDWARE, MAY CAUSE CRACKS.

NOTES

Kit may NOT fit with the following:

- Aftermarket Bumper
- Body Lift or Lowering Kit
- Front Hitch
- Front Tow Hooks
- Oversized Wheels and Tires
- Aftermarket Fog lights

BEFORE YOU START

- Please read the entire product guide before proceeding.
- Ensure all components listed on page 5 are present.
- If you are missing any of the components, call our customer support at (909) 947-0015.
- Do not work on your vehicle while engine is hot.
- Make sure the engine is turned off and the vehicle is in Park or the Parking Brake is set.

1. With the ignition switched off and the parking brake set, disconnect the negative battery cable on the passenger's side.



2. Disconnect the MAF sensor wiring harness (and Pressure Sensor if equipped).



3. Loosen the two hose clamps on the Hump Coupler and one on the throttle body. Then rotate the assembly out of the way.



4. Remove the four screws from the lid. Then remove the lid from the vehicle.



5. Carefully remove the Air Filter/ Adapter tube assembly up out of the air box.

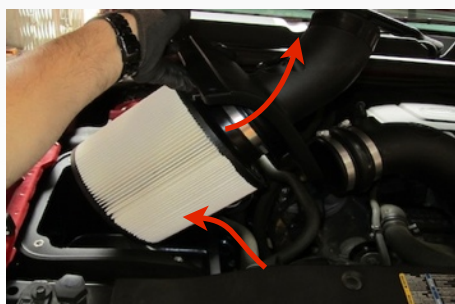

6. From inside the wheel well, remove the screw on the right using a 10mm socket and the panel pin on the left using a flat blade screwdriver.



7. Looking through the bottom of the air box, remove the panel pin mounting the plate between the wheel liner and front support.



8. Using a 7mm socket and extension, position the ratchet through the air box and go around the support to access the other screw mounting the plate. This screw will be reused with the new scoop. Remove the plate from the vehicle from under the truck by pulling down and towards the motor.



SEE EXPLODED VIEW ON PAGE 4



INSTALLATION INSTRUCTIONS (continued)

9. Install the 4 Clip Nuts (B) to the bottom flange of the air box. Be sure that they snap into the holes.



10. Install the Mounting Bracket (F) to the Scoop (A) using two 1/4"-20x1/2" Hex Screws (D) and 1/4" Washers (E).



11. **Chevy Models Only!** Attach the Chevy Bracket (G) to the Scoop (A) using two 1/4"-20x1/2" Hex Screws (D) and 1/4" Washers (E). Then install the Clip Nut (B) onto the bracket.

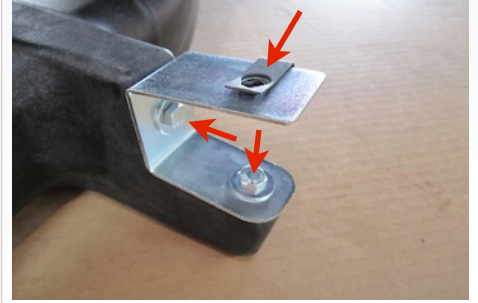

12. Install the scoop assembly up into the bottom of the air box from under the truck.



13. Using the four 1/4-20x1.0" Hex Screws (C) and 1/4" Washers (E) secure the scoop assembly to the air box.

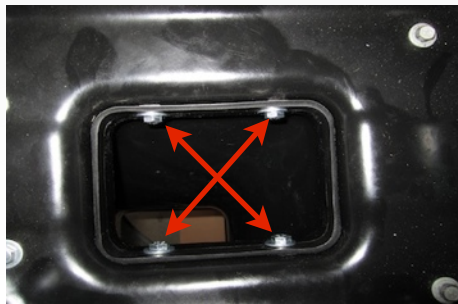

14. Attach the Mounting Bracket to the front support using the OE screw and a supplied 1/4" Washer (E).



15. Reattach the fender liner to scoop using two 1/4"-20x1/2" Hex Screws (D) and 1/4" Washers (E). Chevy models will use one 1/4-20x1.0" Hex Screw (C) securing the fender liner to the Chevy Bracket (G).



16. Check to make sure the Scoop assembly does not interfere with the wheel or wheel well liner. Check all connections to make everything is secure



17. Reinstall the Air Filter/ Adapter tube assembly and lid. Do not use thread locker on lid hardware.

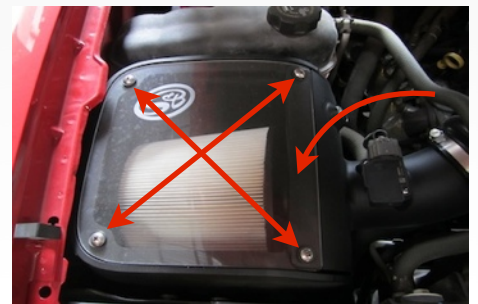

18. Reposition the intake tube and reattach the hump coupler to the filter adapter tube. Tighten all hose clamps when you are satisfied with the position.



19. Reconnect the MAF sensor wiring harness (and Pressure Sensor if equipped).



20. Reconnect the negative battery terminal. Inspect the installation, be sure the kit is properly positioned and all fasteners are secure. Installation is complete!

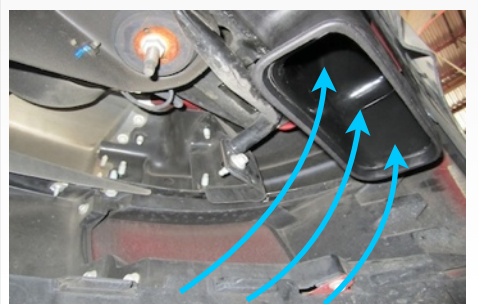

SEE EXPLODED VIEW ON PAGE 5



INSTALLATION INSTRUCTIONS (continued)

Precision II Filter Cleaning & Oiling



Order online today at www.sbfilters.com or
through your local S&B distributor.
Part #: 88-0008

Air Filter Wrap Use with Oiled or Dry Filters



Order online today at www.sbfilters.com or
through your local S&B distributor.
Part #: WF-1035

Testing and Maintenance

- Engage parking brake and start your engine. Listen for abnormal noises. If an air leak is detected, re-inspect hoses and connections as they may need to be repositioned and tightened.
- **S&B FILTERS recommends that you keep your OE intake system in the event it is required in the future.**
- In order to maintain your warranty, all connections and components must be checked periodically for alignment and for proper tension on all connections. Failure to do so may void your warranty.
- Use only S&B FILTERS cleaning and oil products to service your filter. Using any other brand oil and or cleaners on your S&B air filter will void your warranty.

REMINDER!

Water Ingestion Disclaimer:

This product is intended for general highway use only! Under normal driving conditions water ingestion is usually not an issue; however, if the product becomes submerged from rain splashes or mud puddles due to harsh rains or flooding the engine may ingest water which could cause severe engine damage. Do NOT use this product when crossing any body of water including but not limited to large puddles, streams, rivers or lakes.

If your engine ingests water, this could cause severe engine damage by hydro-lock or other conditions. Care should be taken to avoid these driving conditions. **ENGINE DAMAGE CAUSED BY THE INGESTION OF WATER INTO THE ENGINE IS THE DRIVER'S RESPONSIBILITY AND IS NOT COVERED BY S&B FILTERS!**

Scoop Obstruction:

Regularly inspect the entire Scoop Inlet for any obstruction or debris that may impede the flow of air.

Ride Height

Once the Scoop has been installed, make sure there is plenty space between your tire and the scoop before driving. The scoop system may not work with aftermarket wheels and tires.

SEE EXPLODED VIEW ON PAGE 4



INSTALLATION INSTRUCTIONS (continued)

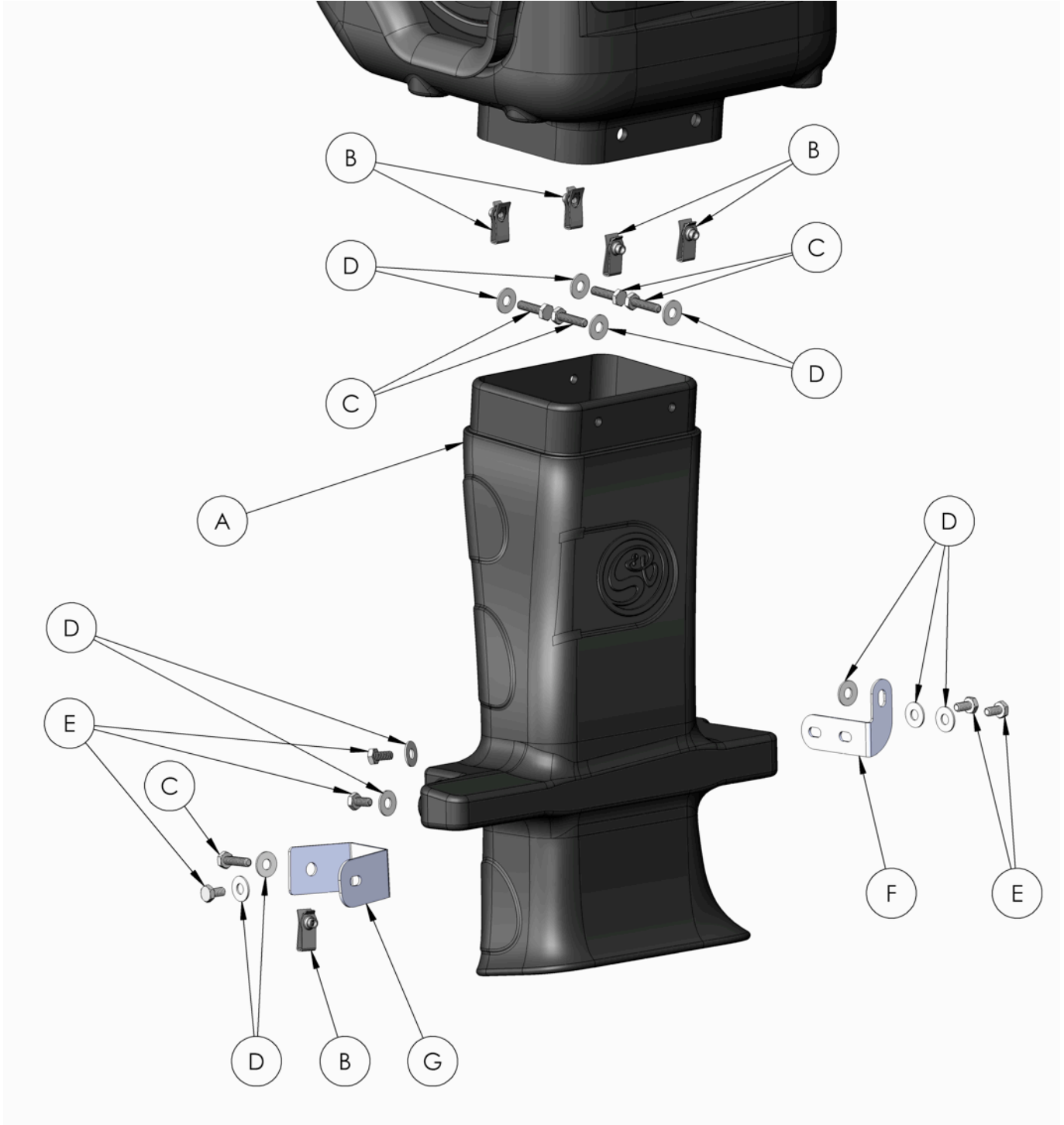

Intake Kit Sold Separately

ITEM	QTY.	DESCRIPTION	P/N
A	1	Cold Air Scoop	AL1188-00
B	5	Nut, Clip, 1/4-20	AI1059-00
C	5	Screw, Hex Cap, 1/4-20x1.0"	AI1131-00
D	13	Washer, Flat, 1/4"	AI1073-00
E	5	Screw, Hex Cap, 1/4-20x1/2"	AI1077-00
F	1	Mounting Bracket	AI1565-00
G	1	Chevy Only Mounting Bracket	AI1566-00

AM0190-00 Rev.A 10/11/12