



## INSTALLATION INSTRUCTIONS

### VEHICLE APPLICATION

Year: **2003 - 2007.5**  
 Make: **Dodge Ram**  
 Model: **2500/3500**  
 Engine: **5.9L Cummins**

### TOOLS REQUIRED

- 8mm, 10mm, 13mm Wrench & Socket
- 1/2" Wrench & Socket
- T20 Torx
- 5/16" Nut Driver or Flat Blade Screwdriver
- Phillips Screwdriver, Pliers or Channel locks

### S&B FILTER MAINTENANCE

- Cleanable (KF-1035). If the enclosed filter is Red, it came pre-oiled from the factory. Please visit [www.sbfilters.com](http://www.sbfilters.com) for exact oil amount required after cleaning.
- Disposable (KF-1035D). If the enclosed filter is White, it is a disposable filter and should be discarded once it reaches capacity. This filter (does not require oil). For more info on S&B's disposable filter, visit [www.sbfilters.com](http://www.sbfilters.com).

### NOTES

Kit may not fit with the following Aftermarket Parts installed:

- Aftermarket Parts
- Body Lift or Lowering Kit
- Custom Hood
- Intercooler or Turbo Upgrades

### CARB STATUS - Pending

Product will be submitted to Air Resources Board for approval shortly.

**Not legal for use in CA or other states adopting CA emissions standards See Page 3 for more info.**

### BEFORE YOU START

- Please read the entire product guide before proceeding.
- Ensure all components listed on page 4 are present.
- If you are missing any of the components, call our customer support at (909) 947-0015.
- Do not work on your vehicle while engine is hot.
- Make sure the engine is turned off and the vehicle is in Park or the Parking Brake is set.

**1.** With the ignition switched off and the parking brake set, disconnect the negative battery cables on both batteries. **Note: Failure to disconnect the battery may cause the CEL to illuminate upon completion of the installation and subsequent operation. Do not skip this step!**

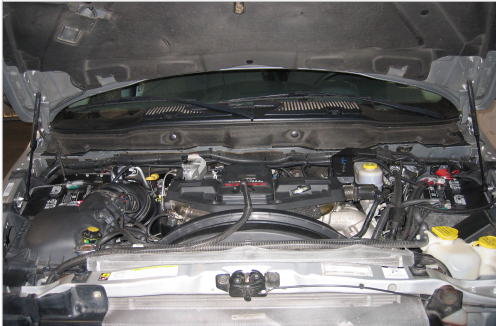

**2.** Disconnect the electrical connection for the Intake Air Temp (IAT) Sensor, then unclip the wire loom from the tube.

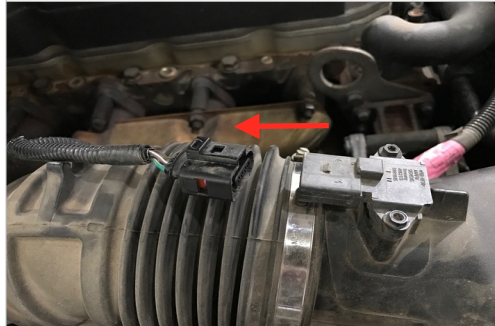

**3.** Loosen the hose clamp connecting the intake tube to the air box lid then remove the mounting nut securing the stock air box. Pull up on the stock air box to remove it from the vehicle.

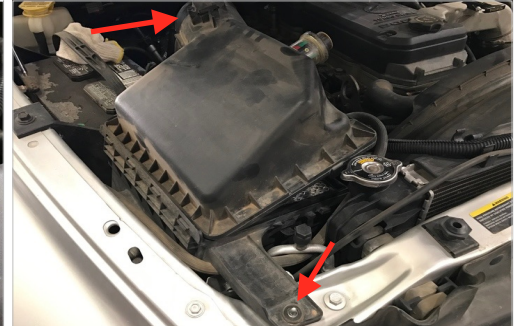

**4.** Loosen the hose clamp at the turbo inlet and then remove the intake tube from the vehicle.

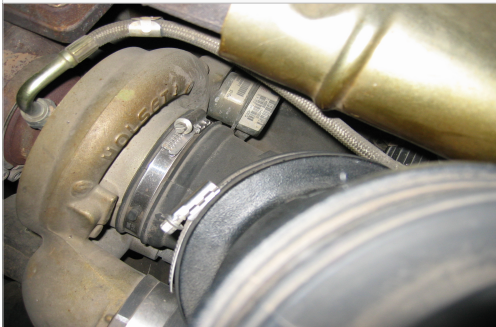

**5.** Install the Tube Seal (C) onto the Air Box (A).



**6. (OPTIONAL)** For those concerned about minimal engine heat; install the Box Plug (K) onto the bottom of the Air Box (A) using the provided 1/4-20 Screws (N), Lock Washers (M), Flat Washers (L) and Locknuts (S). For those seeking additional air flow, set the box plug aside.

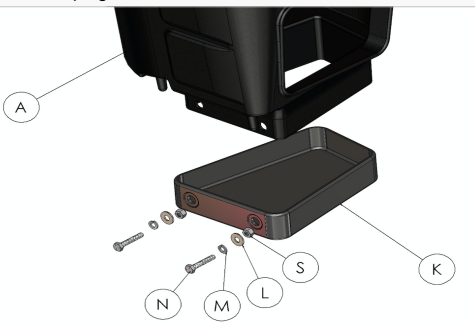

**7.** Carefully remove the IAT sensor from the stock air box lid. Use the supplied 8-32 Screws (J) and IAT Gasket (I) to secure the sensor to the Intake Tube (B). Do not over tighten.



**8.** Slide the Silicone Adapter (F) and two #64 Hose Clamps (G) onto the Intake Tube (B). Make sure not to push the coupler too far deep into the tube. The edge of the coupler should meet up to the back stop bead and the edge of tube should be about half way through the coupler. Tighten the hose clamps on the intake side. Leave the other one loose for now.



SEE EXPLODED VIEW ON PAGE 4



## INSTALLATION INSTRUCTIONS (CONTINUED)

9. Install the Intake Tube (B) onto the turbo. Do not tighten any hose clamps yet. Place the Air Filter (D) and Air Box (A) into the truck. Insert the other end of the air intake tube into the air box. You may have to lift the air box up a little bit to get the air intake tube through the Tube Seal (C). The stop bead on the intake tube should be sealed up to the tube seal. Slide the air filter onto the intake tube and tighten the #88 Hose Clamp (H). Align the box prongs on the bottom of the air box with the grommets on the side of battery tray and push down on the box to completely seat the prongs onto the grommet. Tighten the hose clamp at the turbo.

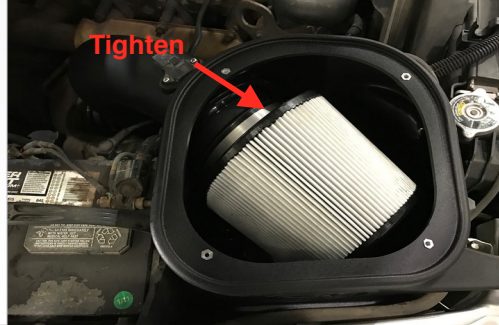
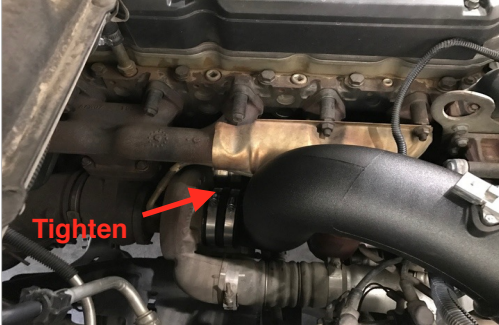

10. Secure the Air Box (A) using the stock mounting nut removed in Step #3.



11. Remove the protective covering on the Clear Lid (E) and install the Edge Trim (R).



12. Place the Clear Lid (E) on top of the Air Box (A) using the supplied 10-24 Screws (O) and Washers (P).

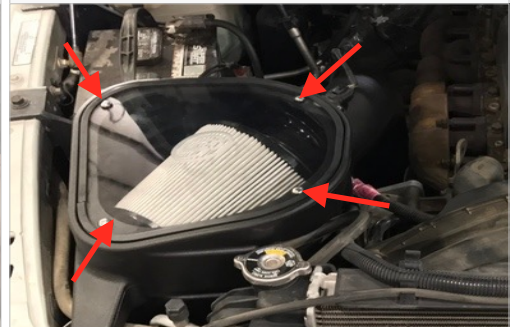

13. Reconnect the electrical connector into the IAT sensor.



14. Reconnect the negative terminal on both batteries. Inspect your installation, make sure the kit is properly positioned and all fasteners are secure. Affix the CARB and ID label near the intake kit. The installation is now complete.



SEE EXPLODED VIEW ON PAGE 4



## INSTALLATION INSTRUCTIONS (CONTINUED)

### RELATED ITEMS FOR YOUR PURCHASE



Air Filter Wrap  
SKU# WF-1023



Replacement Cotton Filter  
SKU# KF-1035



Replacement Dry Filter

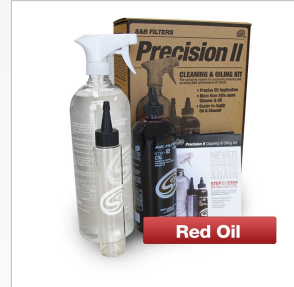

Precision II: Cleaning & Oil Kit  
SKU# 88-0008



Intake Scoop  
SKU# AS-5049



Heater Block  
SKU# 76-1005



Intake Elbow  
SKU# 76-1004-1

Order online today at [www.sbfilters.com](http://www.sbfilters.com) or through your local S&B distributor.

### AIR BOX END CAP TESTING

Stock air boxes are a significant contributor to poor air flow which is why S&B designs custom air boxes with secondary and/or enlarged openings. With that said, S&B recognizes the benefits of cooler air, so we have included a plug to seal off the opening if so desired. For optimal performance, we recommend that the intake be used without the end cap except in conditions of extreme heat.

### PERFORMANCE TESTING

- Engage parking brake and start your engine. Listen for abnormal noises. If an air leak is detected, re-inspect hoses and connections as they may need to be repositioned and tightened.
- S&B FILTERS recommends that you keep your OE intake system in the event it is required in the future.
- In order to maintain your warranty, all connections and components must be checked periodically for alignment and for proper tension on all connections. Failure to do so may void your warranty.
- Use only S&B FILTERS cleaning and oil products to service your filter. Using any other brand oil and or cleaners on your S&B air filter may void your warranty.

### WARNING!

If your vehicle has a Vehicle Emission Control Information decal affixed to the factory airbox, a new replacement label must be obtained and installed in a readily visible position in the engine compartment in order to remain CARB compliant. Failure to do so will prevent the vehicle from passing a smog check. Replacement labels can be ordered from your local dealership. Regulations state that the VECI label shall not be affixed to any equipment which is easily detached from the vehicle. Label placement, under the hood on a painted surface is recommended.

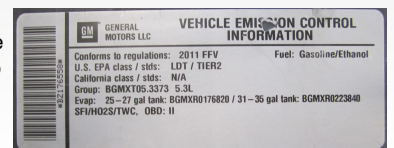

### EMISSIONS STANDARD

The California Air Resource Board (CARB) requires that an E.O. identification label be applied to the vehicle in order to pass a smog check inspection when a Performance Intake Kit has been installed. You must place the E.O. label provided on or near the intake kit after installation so that a smog check technician can easily verify the E.O. number. Check the status of the exemption process by looking up a specific part number at [www.sbfilters.com](http://www.sbfilters.com). The CARB Exemption number and/or status is listed under the Product Details section for each part number. If the status shows as "Pending," CARB has yet to issue an exemption. Products that have not been issued an EO number are street legal in most states, but may not be used on emission controlled vehicles in the state of California and are for off road use only. If you purchased your kit from S&B Filters directly, we will automatically mail you your Exemption Sticker when it is issued to us. If you purchased your kit from an authorized S&B Filters Dealer, log onto our web site and register to receive your Exemption Sticker.

SEE EXPLODED VIEW ON PAGE 4



**EXPLODED VIEW**

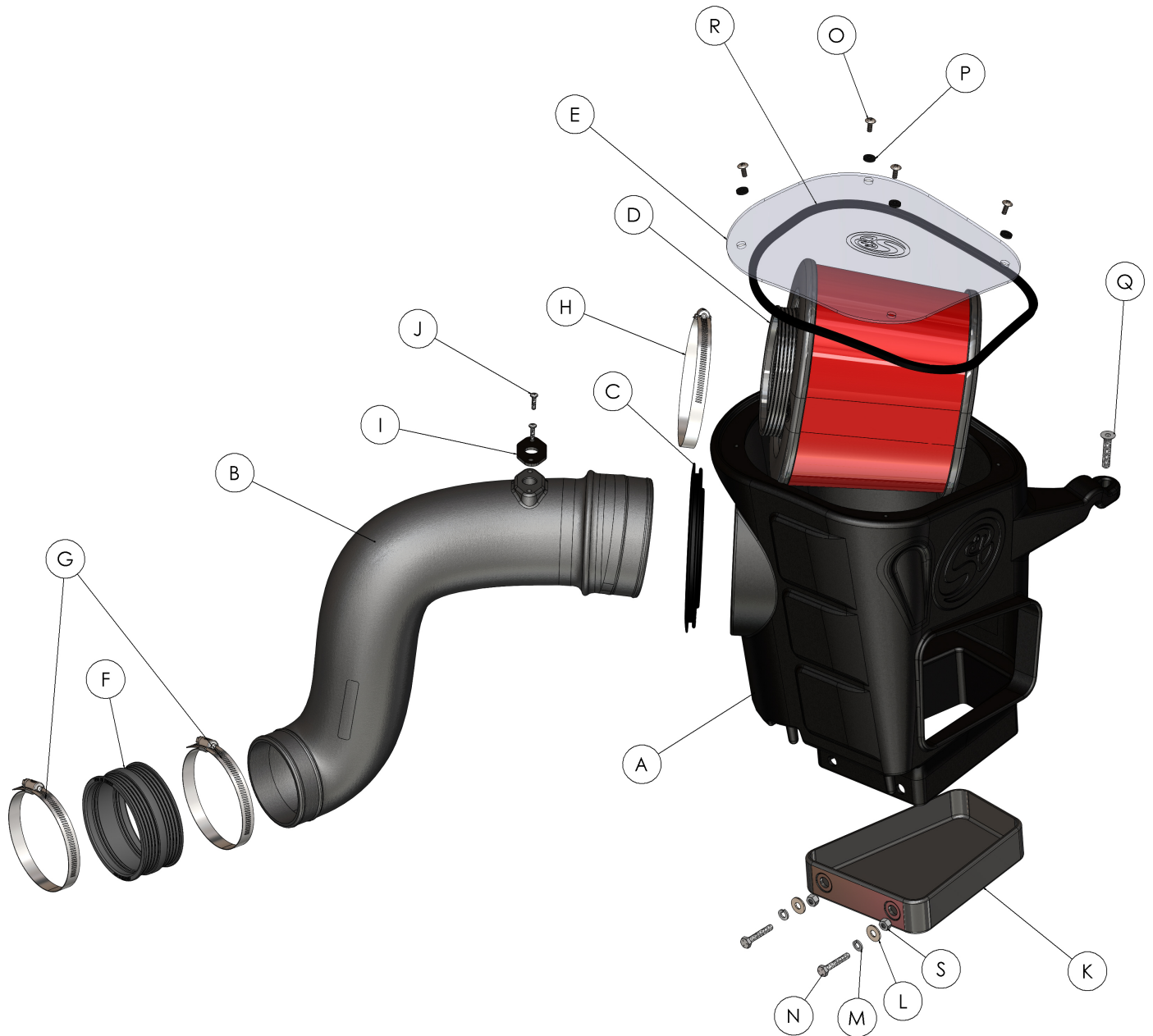

ITEM	QTY.	DESCRIPTION	P/N
A	1	AIR BOX	AL1272-00
B	1	INTAKE TUBE	AL1271-00
C	1	TUBE SEAL	AI1717C-00
D	1	AIR FILTER	KF-1035 or KF1035D
E	1	CLEAR LID	AI1613-00
F	1	SILICONE ADAPTER	AI1029C-00
G	2	HOSE CLAMP, #64	AG1018-00
H	1	HOSE CLAMP, #80	AG1010-00
I	1	IAT SENSOR GASKET	AI1344-00
J	2	SCREW, 8-32 x 5/8"	AI1434-00

ITEM	QTY.	DESCRIPTION	P/N
K	1	BOX PLUG	AL1207-00
L	4	WASHER, FLAT 1/4"	AI1073-00
M	2	WASHER, LOCK, 1/4"	AI1309-00
N	2	SCREW, HEX, 1/4-20 x 1-1/2"	AI1950-00
O	4	SCREW, TRUSS, 10-24 x 5/8"	AI1539-00
P	4	WASHER, SEALING, #10	AI1540-00
Q	1	SCREW, ALLEN, M8 x 1.25" x 40mm	AI1369-00
R	1	EDGE TRIM	AI1636-01
S	2	LOCKNUT, 1/4-20	AI1074-00