

# INSTALL INSTRUCTIONS FOR 75-5060



**PART#: 75-5060 / 75-5060D**

## Vehicle Application

**YEAR:** 2012 - 2016

**MAKE:** Jeep

**MODEL:** Wrangler JK

**ENGINE:** 3.6L

**Note:** This intake kit may not fit with the following Aftermarket Parts installed:

- Body Lift or Lowering Kit
- Custom Hood
- Throttle Body Spacer / Upgrade

## Tools Required

- 10mm Wrench & Socket
- 5/16" Nut Driver & 1/4" Nut Driver or Flat Blade Screwdriver
- Phillips Screwdriver, Pliers or Channel locks

**Note:** Approximate Install Time: 1 Hr 00 Mins.

## S&B Filter Maintenance

KF-1057 Cotton Cleanable : If the enclosed filter is RED, it came pre-oiled from the factory. Click [here](#) for exact oil amount required for cleaning.

KF-1057D Dry Extendable : If the enclosed filters is WHITE, it is a disposable filter and should be discarded once it reaches capacity. This filter does not require oil.

## CARB Status - Pending

Product will be submitted to Air Resources Board for approval shortly

\*Not legal for use in CA or other states adopting CA emissions standards.

## Before You Start

- Please read the entire product guide before proceeding.
- Ensure all parts are present.
- If you are missing any of the components, call our customer support at (909) 947-0015.
- Do not work on your vehicle while the engine is hot.
- Make sure the engine is turned off and the vehicle is in Park or the Parking Brake is set.

## Related Products

- Cotton Cleanable Filter (KF-1057)
- Dry Extendable Filter (KF-1057D)
- Cleaning & Oiling Kit (88-0008)
- Air Filter Wrap (WF-1058)

## Performance Testing

- After your installation is complete engage parking brake and start your engine. Listen for abnormal noises. If an air leak is detected, re-inspect hoses and connections as they may need to be repositioned and tightened
- S&B FILTERS recommends that you keep your OE intake system in the event it is required in the future.
- In order to maintain your warranty, all connections and components must be checked periodically for alignment and for proper tension on all connections. Failure to do so may void your warranty.
- Use only S&B FILTERS cleaning and oil products to service your filter. Using any other brand oil and or cleaners on your S&B air filter may void your warranty.

## Warning!

If your vehicle has a Vehicle Emission Control Information decal affixed to the factory airbox, a new replacement label must be obtained and installed in a readily visible position in the engine compartment in order to remain CARB compliant. Failure to do so will prevent the vehicle from passing a smog check. Replacement labels can be ordered from your local dealership. Regulations state that the VECI label shall not be affixed to any equipment which is easily detached from the vehicle. Label placement, under the hood on a painted surface, is recommended.

## Emission Standard

The California Air Resource Board (CARB) requires that an E.O. identification label be applied to the vehicle in order to pass a smog check inspection when a Performance Intake Kit has been installed. You must place the E.O. label provided on or near the intake kit after installation so that a smog check technician can easily verify the E.O. number. As of April 2009, S&B has never had a product where CARB denied an exemption request; however, the exemption process with CARB can take as long as 18 months. Check the status of the exemption process by looking up a specific part number at [www.sbfilters.com](http://www.sbfilters.com). The CARB Exemption number and/or status is listed under the Product Details section for each part number. If the status shows as “Pending,” CARB has yet to issue an exemption. Products that have not been issued an EO number are street legal in most states, but may not be used on emission controlled vehicles in the state of California and are for off-road use only. If you purchased your kit from S&B Filters directly, we will automatically mail you your Exemption Sticker when it is issued to us. If you purchased your kit from an authorized S&B Filters Dealer, log onto our web site and register to receive your Exemption Sticker.

# EXPLODED VIEW

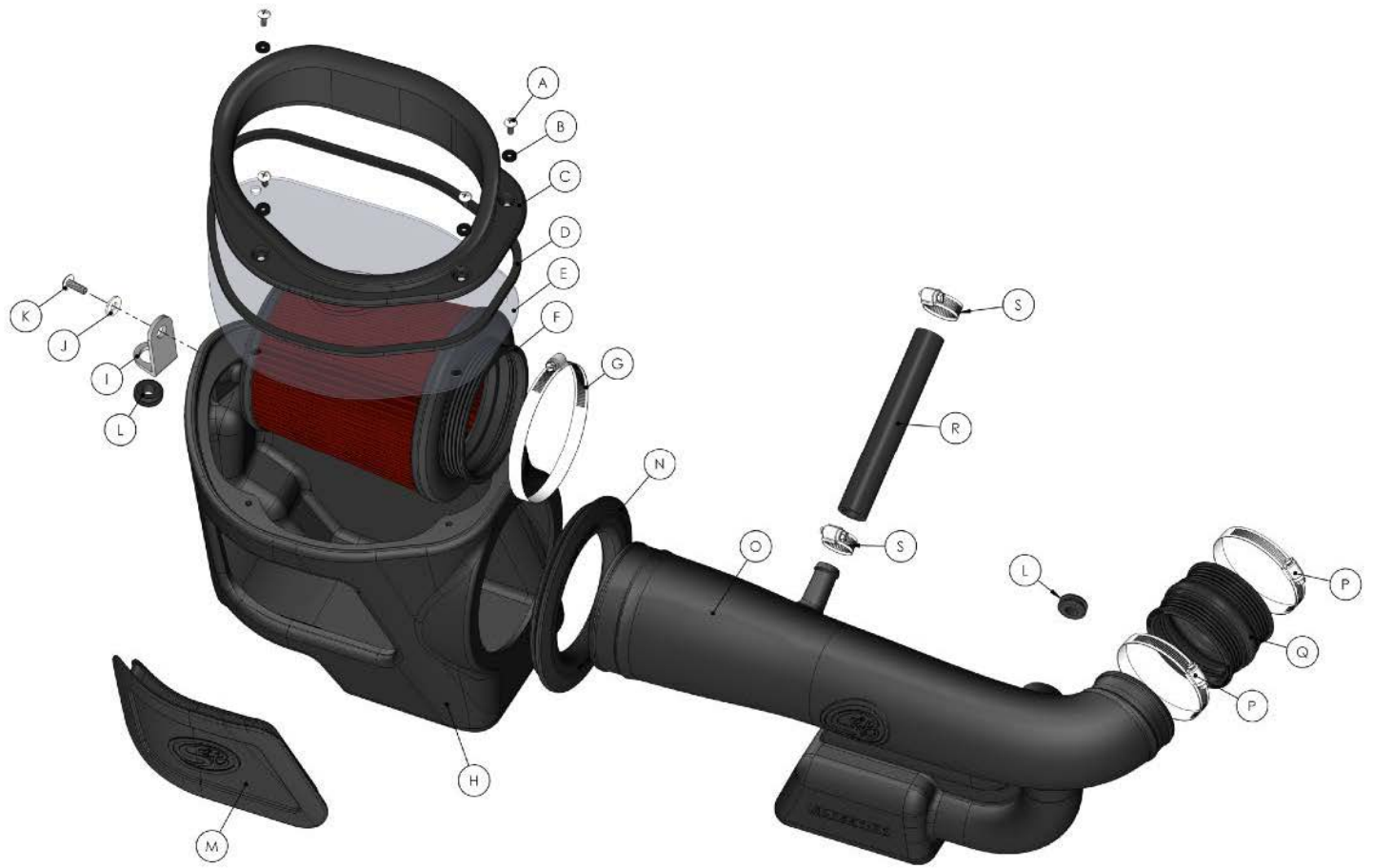

PARTS LIST

ITEM	QTY.	DESCRIPTION	P/N	ITEM	QTY.	DESCRIPTION	P/N
A	4	#10-24 X 5/8" Truss Head Screw	AI1539-00	O	1	Air Tube	AL1231-01
B	4	#10-24 Rubber Washers	AI1540-00	P	2	Hose Clamp, #52	AG1007-00
C	1	Silicone Hood Seal	AI1681C-00	Q	1	Hump Coupler	AI1601C-00
D	1	Lid Edge Trim	AI1636-06	R	1	Crank Case Hose	AI1040-08
E	1	Lid	AI1680-00	S	2	Hose Clamp, #12	AG1030-00
F	1	Air Filter	KF-1057	U	1	Loctite Thread Locker	AI1595-00
G	1	Hose Clamp, #80	AG-1009-00	ITEMS NOT SHOWN IN THE EXPLODED VIEW			
H	1	Air Box	AL1231B-00	T	2	Loop Clamp	AI1511-00
I	1	Bracket	AI1696-00				
J	1	1/4"-20 Washer	AI1073-00				
K	1	1/4"-20 x .625" Truss Head Screw	AI1569-00				
L	2	Grommets	AI1563-00				
M	1	Silicone Box Seal	AI1682C-00				
N	1	Tube Seal	AI1650C-00				

# INSTALLATION STEPS

## STEP 1

With the ignition switched off and the parking brake set, disconnect the negative battery cable on the battery.

**Note:** Failure to disconnect the battery may cause the CEL to illuminate upon completion of the installation and subsequent operation. Do not skip this step!



## STEP 2

Lift and remove the plastic engine cover.



## STEP 3

Loosen the hose clamp at the throttle body and pull the tube out.



## STEP 4

Remove the two retaining bolts on the stock intake tube.

**Note:** You will need to reuse the retaining bolts to secure the radiator hose on Step 24.





## STEP 5

Loosen the hose clamp at the stock airbox and pull the tube out.



## STEP 6

Once everything is loosened, pull the intake tube out exposing the IAT sensor.



## STEP 7

Lift the tab on the IAT sensor and use pliers if necessary to turn it counterclockwise and remove it from the tube. Be careful not to break the sensor. Remove the sensor from its harness. Pull the intake tube out completely.

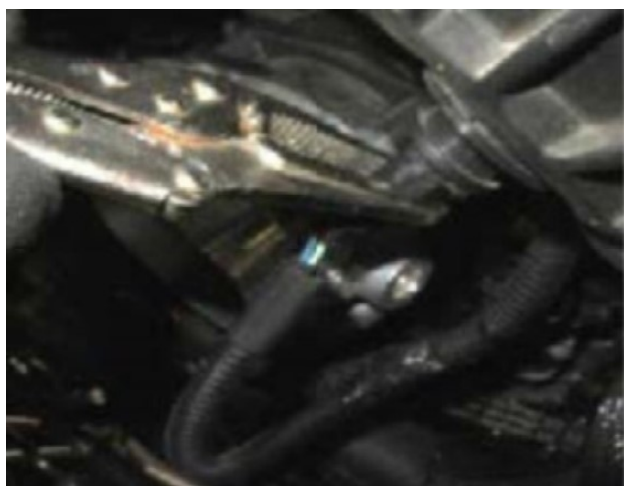

## STEP 7 (IMAGE 2)

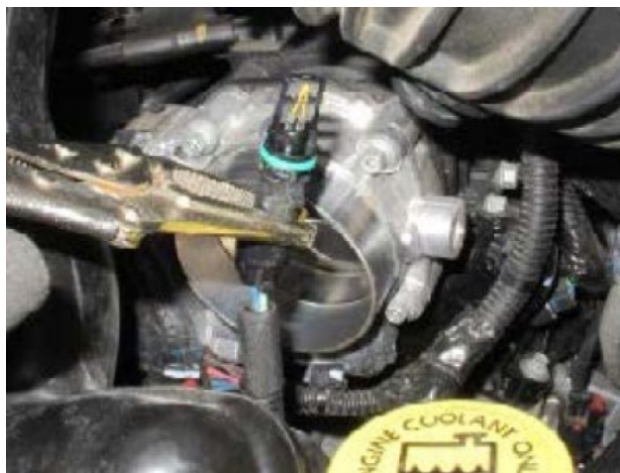

### STEP 7 (IMAGE 3)



### STEP 8

Pull the stock CCV hose from the air box and the breather line. For the breather line, use a flat blade screwdriver if necessary to pry the hose off the line. Be careful not to damage the breather line. Remove the hose completely.



### STEP 8 (IMAGE 2)



### STEP 9

Once the sensor and breather are out, remove the stock airbox completely by pulling up. Be careful not to break the factory box tabs.



## STEP 10

Install the Tube Seal (N) by pushing the seal into the Airbox (H).



## STEP 11

Install the Air Tube (O) into the Airbox (H) by pushing the tube through the Tube Seal (N).



## STEP 12

Slip the Air Filter (F) over the Air Tube (O) and tighten down the #80 Hose Clamp (G).



## STEP 13

Install the Hump Coupler (Q) to the Air Tube (O) and tighten down the #52 Hose Clamp (P) on the tube end. Leave the other clamp on the coupler that goes into the throttle body loose.





## STEP 14

Install the Bracket (I) to the side of the Airbox (H) with the supplied Screw (K) and Washer (J). Apply Loctite Thread Locker (U) to the threads on the Screw (K) before installing the bracket. Insert the Grommet (L) in between the hole on the bottom end of the bracket.



## STEP 14 (IMAGE 2)



## STEP 15

Install the Grommet (L) to the bottom of the Air Tube (O).



## STEP 16

Reinstall the IAT sensor into the Air Tube (O) by pushing the sensor into the Grommet (L). Seat the sensor into the grommet until the O-ring is not visible.



## STEP 17

Locate the bolt on the side of the plastic tray that holds the stock intake box and remove it.



## STEP 18

Choose the setup you prefer.

- **Configuration 1:** Silicone Hood Seal (C) and Silicone Box Seal (M) Installed.
- **Configuration 2:** Silicone Hood Seal (C) Installed and Silicone Box Seal (M) Not Installed.
- **Configuration 3:** Lid (E) Installed and Silicone Box Seal (M) Not Installed.

- **Note:** Configuration 3 is the default setup for this installation instructions.

**Warning:** Do not install the Polycarbonate Lid with the Silicone Airbox plug. Doing this will cause your filter to collapse and will void your warranty.

## STEP 19

Drop in the Air Tube (O) and reinstall the harness back into the IAT sensor.



## STEP 20

Install the Airbox (H) until the tabs snap into the factory grommets. Align the bracket with the hole on the plastic tray. Reuse the bolt from the plastic tray to tighten down the airbox.

**Note:** If Configuration 1 is chosen, insert the Box Seal (M) before installing the Airbox (H)



### STEP 21

Install the Hump Coupler (Q) into the throttle body and tighten down the #52 Hose Clamp (P).



### STEP 22

Install the Crankcase Hose (R) onto the Air Tube (O) and tighten the #12 Hose Clamp (S).



### STEP 23

Slip the other end of the Crankcase Hose (R) onto the crankcase vent tube. Tighten down the #12 Hose Clamp (S) to secure the hose.

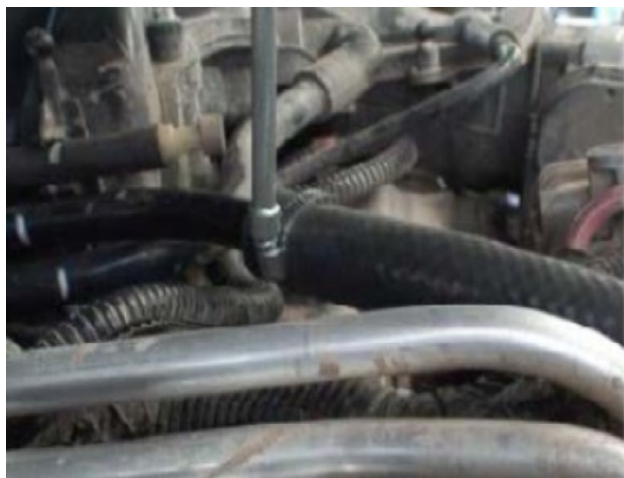

### STEP 24

Use the two provided Loop Clamp (T) and reuse the retaining bolt to secure the radiator hose.





## STEP 25

(Optional Step) Remove the protective covering from the Lid (E) and install the Lid Edge Trim (D). Place the lid on top of the Airbox (H) and secure the lid using the four provided Screw (A) and Washer (B).

**Note:** Install your Silicone Hood Seal (C) using the provided screws and washers if Configuration 1 or 2 was chosen.



## STEP 25 (IMAGE 2)



## STEP 26

Reinstall the plastic engine cover.



## STEP 27

Reconnect the battery. Inspect your installation, make sure the kit is properly positioned and all fasteners are secure. The installation is now complete.





## KIT SPECIFIC FEATURES

\*The 75-5060 kit has three airflow configurations that you can choose from depending on your airflow requirements.

The airflow restriction for all three configurations are very similar. Choosing one over another would have minimal effect on performance.

**Warning:** Do not install the Polycarbonate Lid with the Silicone Airbox plug. Doing this will cause your filter to collapse and will void your warranty.

## CONFIGURATION 1

• **Configuration 1:** Silicone Hood Seal and Silicone Airbox Plug installed.



## CONFIGURATION 2

• **Configuration 2:** Silicone Hood Seal installed and Silicone Airbox Plug not installed.



## CONFIGURATION 3

• **Configuration 3:** Polycarbonate Lid installed and Silicone Airbox plug not installed.

